

This custom kit is manufactured by Snowbear Company to fit:
PROFESSIONAL MOUNT ASSEMBLY

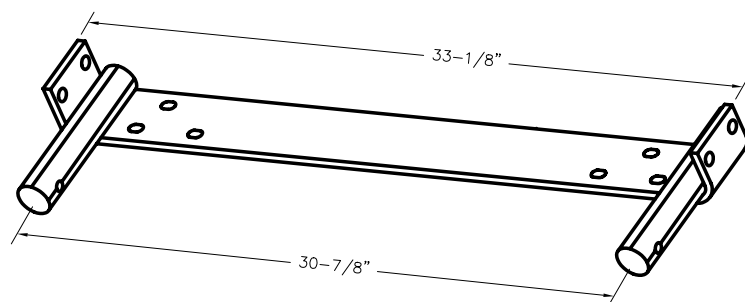
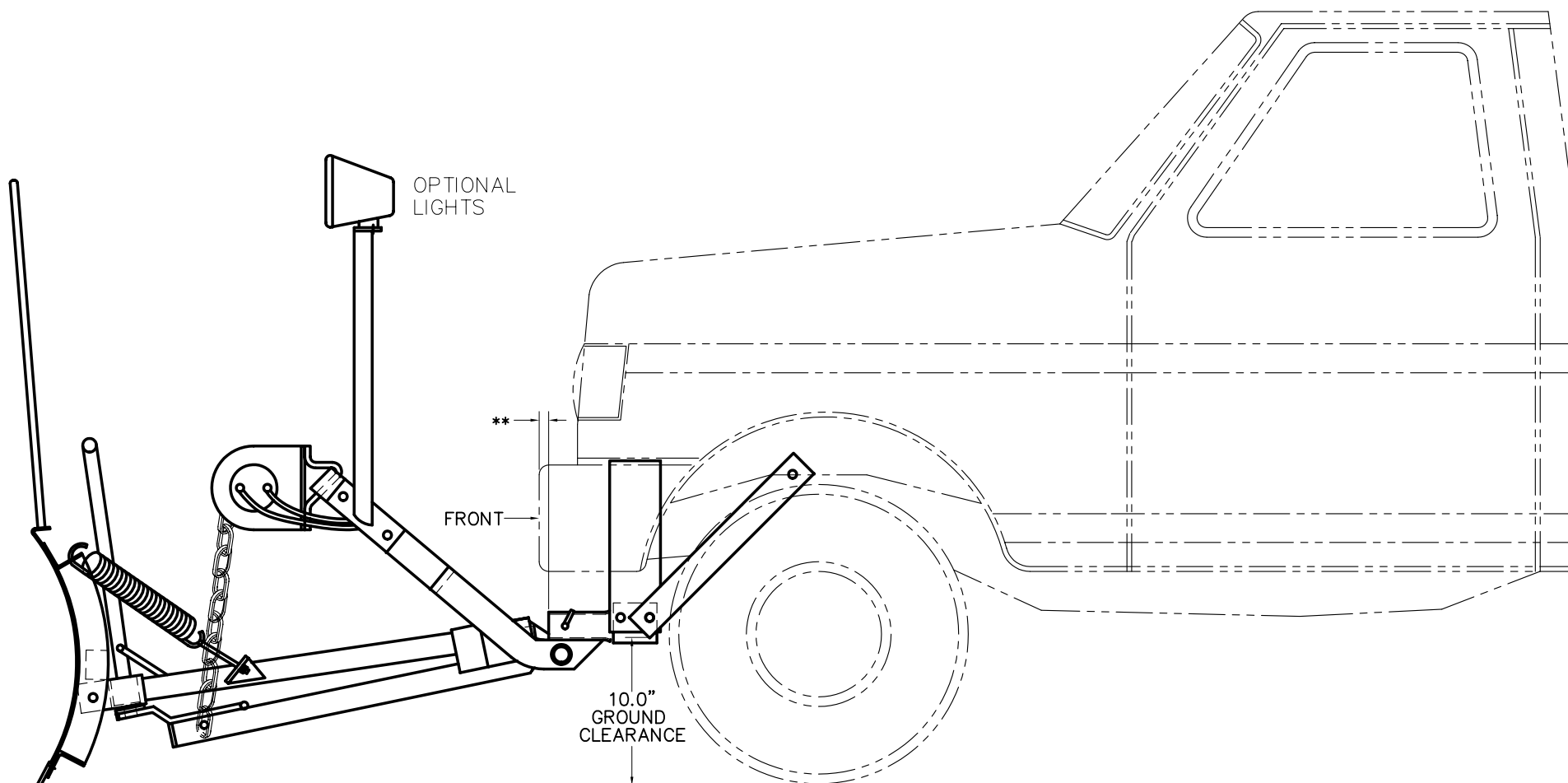

CROSSMEMBER DIMENSIONS

** THE CROSSMEMBER MUST BE MOUNTED WITHIN 6" OF THE FURTHEST POINT FORWARD ON THE FRONT OF THE VEHICLE (BUMPER, BUSHGUARD, WINCH ETC.)

1. THESE PARTS SHOULD BE ARRANGED IN A SIMILAR MANNER TO FASTEN THE MOUNT ONTO THE VEHICLE
2. IT IS THE INSTALLER'S RESPONSIBILITY TO MODIFY THE FRAME AND COMPONENTS OF THE BRACKET IN ORDER TO CREATE A SAFE AND SECURE MOUNT.

* NOTE: USE FLAT WASHERS
ON SLOTTED HOLES.

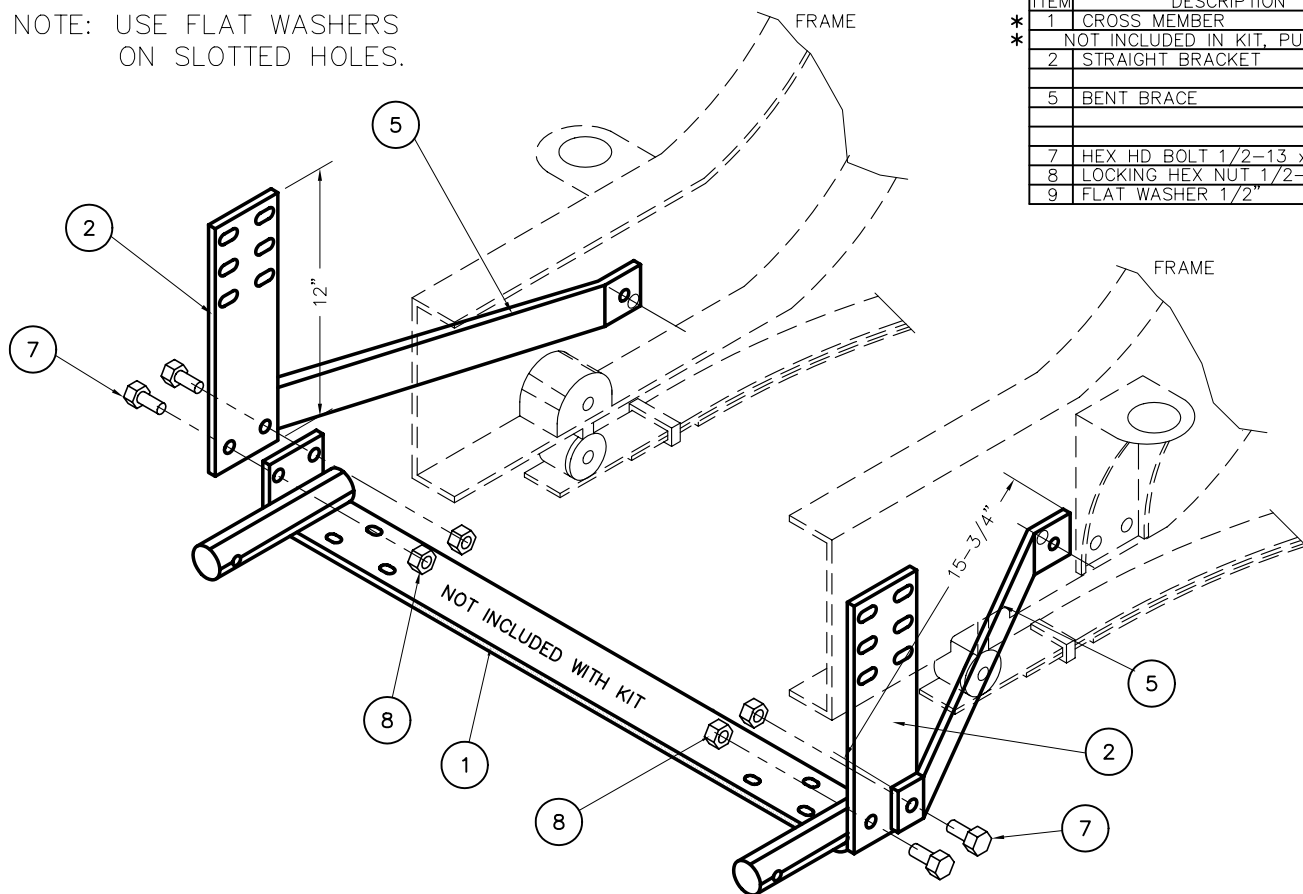

ITEM	DESCRIPTION	PART #	QTY.
* 1	CROSS MEMBER	5XM5	1
*	NOT INCLUDED IN KIT, PURCHASE SEPARATELY		
2	STRAIGHT BRACKET	50001A	2
5	BENT BRACE	50001D	2
7	HEX HD BOLT 1/2-13 x 1 1/2	72510	12
8	LOCKING HEX NUT 1/2-13	72595	12
9	FLAT WASHER 1/2"	72580	12

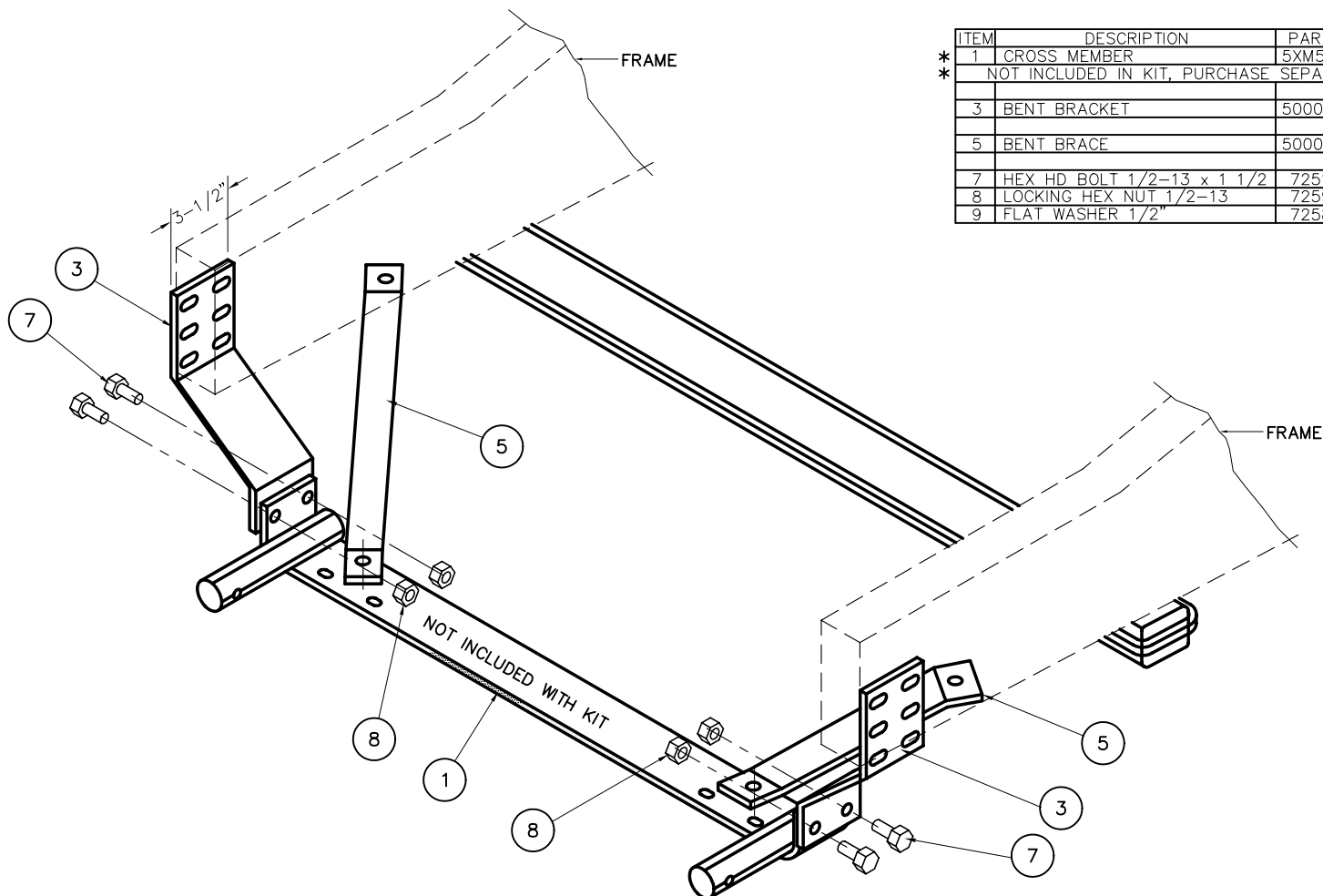

ITEM	DESCRIPTION	PART #	QTY.
* 1	CROSS MEMBER	5XM5	1
*	NOT INCLUDED IN KIT, PURCHASE SEPARATELY		
3	BENT BRACKET	50001B	2
5	BENT BRACE	50001D	2
7	HEX HD BOLT 1/2-13 x 1 1/2	72510	12
8	LOCKING HEX NUT 1/2-13	72595	12
9	FLAT WASHER 1/2"	72580	12

ITEM	DESCRIPTION	PART #	QTY.
* 1	CROSS MEMBER	5XM5	1
* 1	NOT INCLUDED IN KIT, PURCHASE SEPARATELY		
3	BENT BRACKET	50001B	2
5	BENT BRACE	50001D	2
7	HEX HD BOLT 1/2-13 x 1 1/2	72510	12
8	LOCKING HEX NUT 1/2-13	72595	12
9	FLAT WASHER 1/2"	72580	12

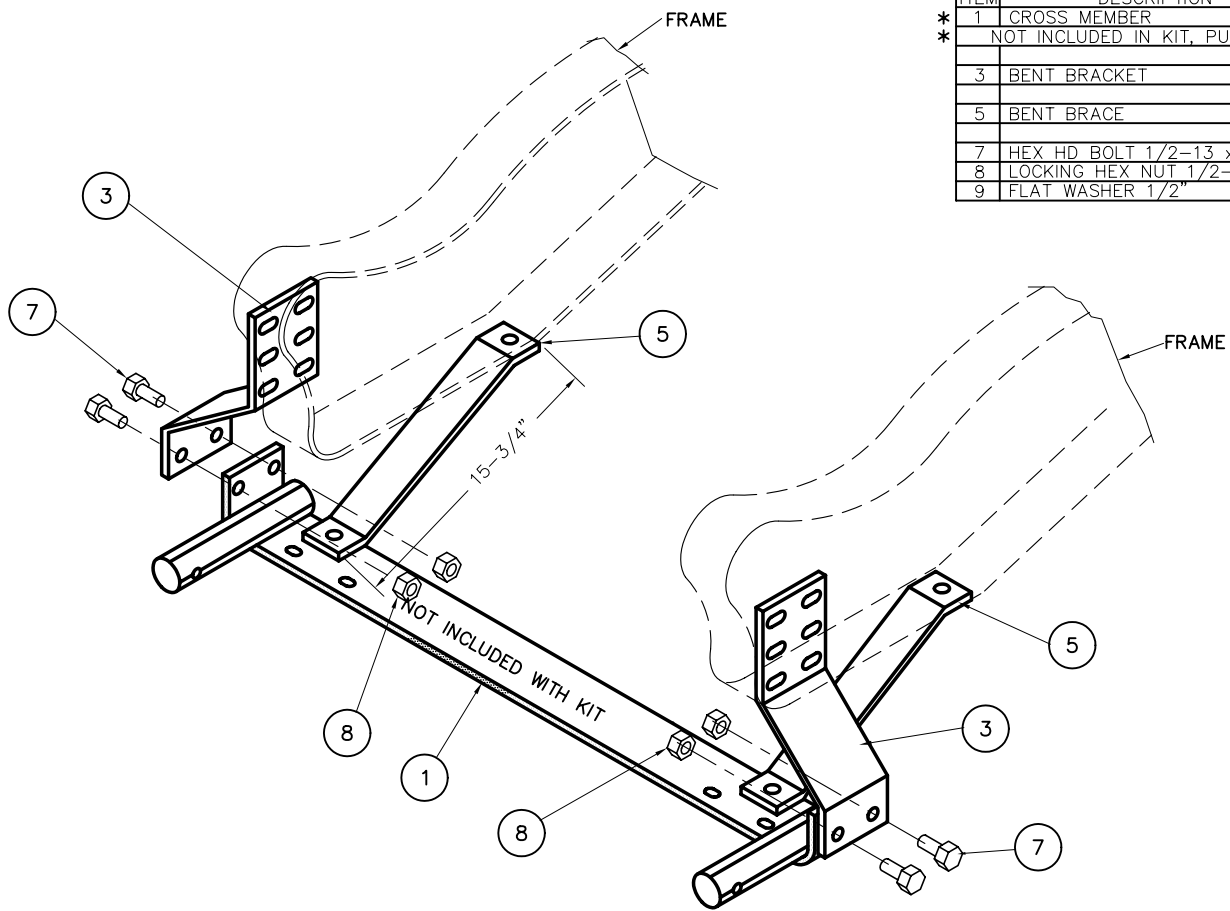

ITEM	DESCRIPTION	PART #	QTY.
* 1	CROSS MEMBER	5XM5	1
* 1	NOT INCLUDED IN KIT, PURCHASE SEPARATELY		
3	BENT BRACKET	50001B	2
4	STRAIGHT BRACE	50001C	2
7	HEX HD BOLT 1/2-13 x 1 1/2	72510	12
8	LOCKING HEX NUT 1/2-13	72595	12
9	FLAT WASHER 1/2"	72580	12

